

Polar Star Expeditions

AROUND THE RUGGED ROCK 2009

St. John's, Newfoundland – Halifax, Nova Scotia

10 days / 9 nights

September 27 – October 6, 2009

Welcome to Newfoundland and Labrador! Come to the Far East of the Western world... where North America wakes up first. With over 1,500 kms of coastal and cross-island hiking trails through a landscape so huge and untouched – you can get lost in her beauty. Come and immerse yourself in a land with a culture and heritage unlike anywhere else in the world. A modern, vibrant society that still retains its old world charm. There's a story to be told and a song to be heard in every bay. A haven for the creative and performing arts inspired by a passion for the landscape and a fascinating history. Come and discover yourself in Newfoundland and Labrador. Experience her magic!

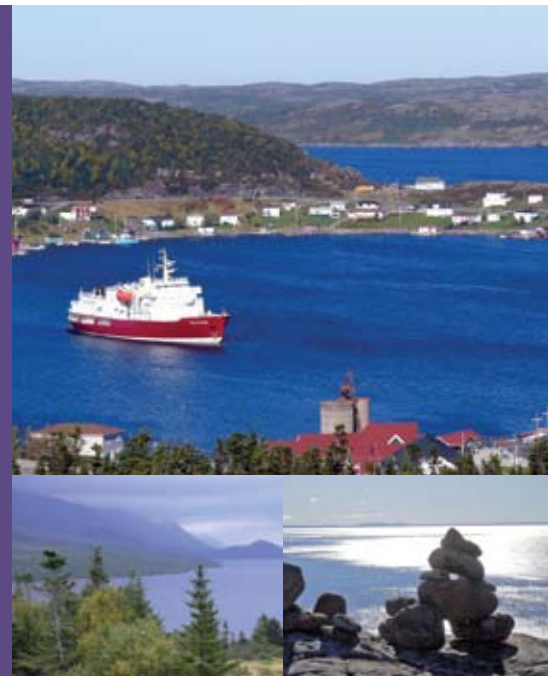

ITINERARY

Day 1: Sunday, 27 September, ST. JOHN'S – Embark M/V Polar Star in vibrant St John's, North America's oldest city. It is here at Signal Hill that Guglielmo Marconi sent the first wireless transatlantic signal to England in 1901. Late afternoon, we set sail from the city's beautiful naturally sheltered harbour to begin our journey "around the rugged rock".

Day 2: Monday, 28 September, BONAVIDA – We visit historic Bonavista, where Italian explorer Giovanni (John) Cabot made landfall in 1497 after crossing the Atlantic from Bristol. While here, we take a tour of the replica of Cabot's ship, the Matthew and visit the Ryan Premises, a restored Merchant's premises that tells the story of the 500 year old fishing industry in Newfoundland. Also at Bonavista, is the unique and historic lighthouse at Cape Bonavista.

Day 3: Tuesday, 29 September, ST. ANTHONY, L'ANSE AUX MEADOWS & NORSTEAD – At the northern tip of Newfoundland is St. Anthony, home to Sir Wilfred Grenfell, a philanthropic physician and missionary. In the afternoon, we visit L'Anse aux Meadows, a UNESCO world heritage site and the only authenticated Viking settlement in North America as well as the reconstructed Viking village site of Norstead. It is an excellent insight into the early life of Viking explorers.

Day 4: Wednesday, 30 September, BATTLE HARBOUR & RED BAY – Today we make two excursions along the coast of Labrador. The preserved community of Battle Harbour is an insight into the bygone days of the Labrador Schooner Fishery. The 16th Century Basque Whalers settled Red Bay which today houses an excellent interpretive centre.

Day 5: Thursday, 1 October, GROS MORNE NATIONAL PARK – This park is both beautiful and geologically significant. Beyond the natural scenery and fantastic hiking, it is most noted for the Tablelands, a 600-meter high plateau that forms one of the world's best examples of ancient rock exposed from the earth's interior. The park is also home to 239 species of birds as well as mammals including Moose, Caribou, Black Bear and Arctic Hare.

Day 6: Friday, 2 October, CODROY RIVER VALLEY – This beautiful river valley is our site for a wonderful Zodiac cruise up river to visit the local community. We also plan to visit a local wildlife taxidermist and his private museum.

Day 7: Saturday, 3 October, GREY RIVER & FRANCOIS – In the morning we explore Grey River Fjord that separates into three river systems. It is noted for its breathtaking scenery with lush forests, rugged mountains and sandy beaches as well as the possibility

to see moose and caribou. Next, we visit the tiny outpost village of Francois at the head of a dramatic fjord surrounded by dramatic rock strewn cliffs. There is time for a stroll or a hike before we gather to enjoy a traditional "kitchen party".

Day 8: Sunday, 4 October, ST. PIERRE, FRANCE – St Pierre is a tiny piece of Europe and this is a unique opportunity to visit this nugget of French culture. While here, explore the charming community and perhaps sample some French specialties. If time permits, we will Zodiac across the bay to explore a reconstructed early settlers' community.

Day 9: Monday, 5 October, LOUISBOURG – We visit the Fortress of Louisbourg National Historic Site, the largest historical reconstruction in Canada. The French began building the fortress in 1719 to serve as the first line of defence against the British in their struggle for North America. Although the fortress walls were destroyed in battle in 1758, today the reconstructed fortress allows us to step back in time and watch the re-enactment of everyday life and work from centuries ago.

Day 10: Tuesday, 6 October, HALIFAX – Our exploration of these special areas of the Atlantic coastline shrouded in autumn colours comes to a close. Disembark in charming historic Halifax – a perfect blend of cosmopolitan amenities and small community friendliness.

Itinerary subject to change.

2 FOR 1 SPECIAL

Category	Brochure Rate per person USD	Special Price* per person USD
K1-D Twin	\$6,440	\$3,220
K2-D Twin	\$7,360	\$3,680
K3-D Twin	\$7,590	\$3,795
K4-D Double	\$8,070	\$4,035
K6-D Double	\$8,770	\$4,385
K7-D Double	\$9,460	\$4,730

*Special late offer price in effect until October 31, 2008. Port charges \$135 per person included in above rates. Fuel surcharges of \$160 per person are additional; prices are in US funds per person.

This offer may be withdrawn by the cruise line without notice. Pricing and availability is on a first-come, first-served basis. All categories except K1 have private bathroom. K1 shares bathroom with one other cabin. Triple and single occupancy prices on request.



EXCLUSIVE
TOURS

POLAR STAR DECK PLAN

LEGEND

Common Areas
Corridors
Outside Decks
Designated Areas
Restricted Areas - Tours Only
No Admittance at all

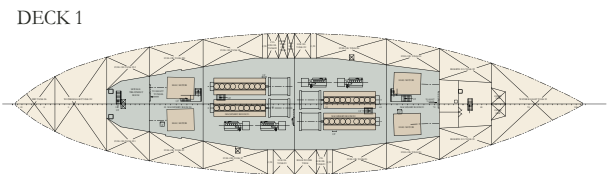
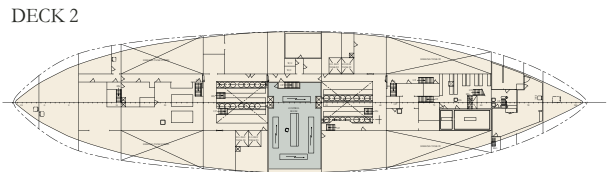
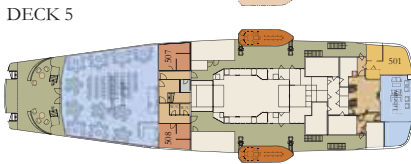
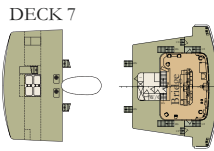
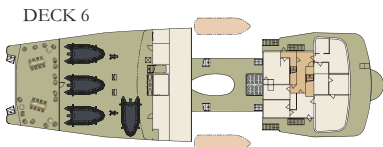
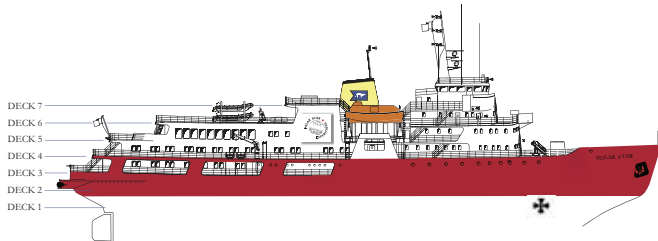

K1 Twin or Triple Suite	K2 Standard Double	K3 Std. Plus Double	K4 Superior Double	K6 Mini Suite	K7 Suite
-----------------------------------	------------------------------	-------------------------------	------------------------------	-------------------------	--------------------



K1



K2 & K3



K4



K6



K7

Triple/Double cabins: Two lower and one upper berths. Sharing toilet, shower & washbasin. Approx. 100 sq. feet/10 sq. metres. Portholes.

Double cabins: Two lower beds. Private bathroom with shower, toilet & washbasin. Approx. 115 sq. feet/11.5 sq. metres. Large windows (K2 windows on deck 3 partially obstructed, one opens; K2 on deck 4 non opening; K3 cabins all have large windows, one opens).

Superior cabins, double or triple use: Double bed, couch can be made up as bed. Private bathroom with shower, toilet & washbasin. Approx. 140 sq. feet/14 sq. metres. 2 side facing windows (one opens) and 1 aft porthole or window.

Mini suites: Double bed, some in alcove, couch can be made up as bed in some. Private bathroom with shower, toilet & washbasin. Approx. 180 sq. feet/18 sq. metres. Large windows, some with one opening.

Suites: Sleeping area in separate area (double bed in 501, 2 singles in 401 – can convert to double), couch in living room can be used as a single bed. Private bathroom with shower, toilet & washbasin. Approx. 250 sq. feet/25 sq. metres. Forward & side facing windows, some open.

Space is limited.

Call your small ship cruise expert today!

Terms & conditions of sale are available upon request, or may be viewed in the 2008 Exclusive Tours brochure, or www.exclusivetours.ca

1.800.268.1820

info@exclusivetours.ca

www.exclusivetours.ca

